

NOTES:

1. FITS: FH15xx Series, CS118, CS121
2. NET WEIGHT: 17.0 lb / 7.7 kg
3. MATERIAL: 7 GA ASTM A36 STEEL
4. INCLUDES HARDWARE KIT
5. USE FOR OVERHEAD CEILING MOUNT ONLY

REVISIONS

| REV | DESCRIPTION                         | APPR / DATE |
|-----|-------------------------------------|-------------|
| 1   | NEW ISSUE                           | RAF 4/21/20 |
| 2   | ADD CS SUBS TO NOTE 1               | RAF 5/6/20  |
| 3   | ADD BRACKET MATERIAL TO NOTES       | RAF 8/5/21  |
| 4   | UPDATED MOUNTING HOLE SPACING       | RAF 3/4/22  |
| 5   | ADD "CEILING MOUNT" TO DESCRIPTIONS | RAF 4/4/23  |

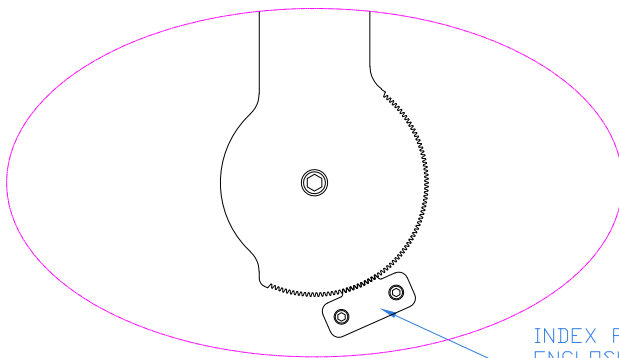
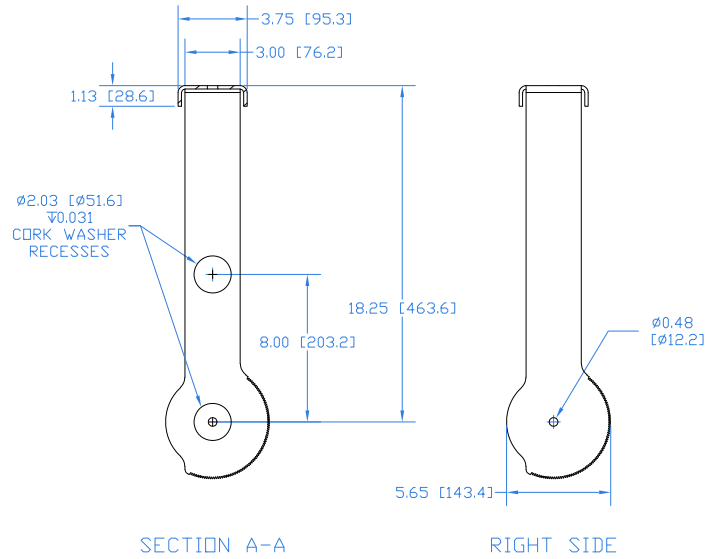
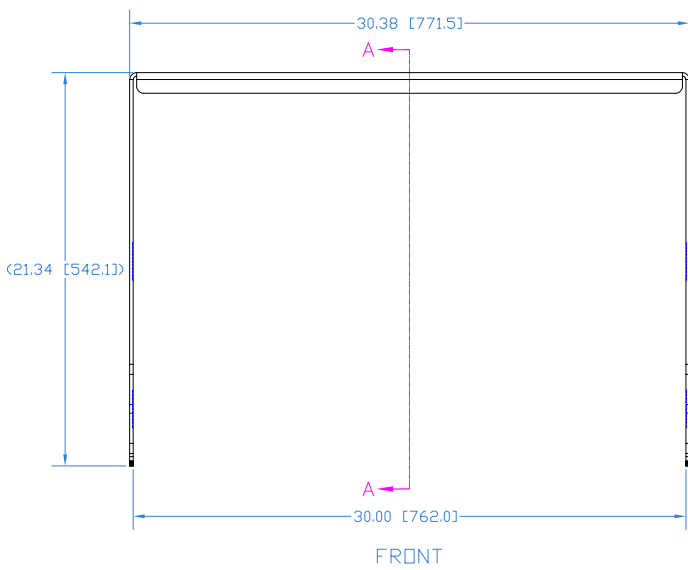
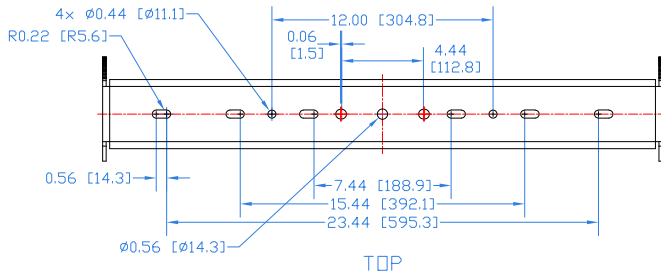

INDEX PLATE BOLTS TO ENCLOSURE TO FIX TILT ANGLE IN 2° INCREMENTS (SHOWN 2X SCALE)

INDEX PLATE (2 pcs)

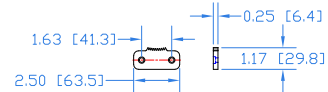

THIRD ANGLE PROJECTION

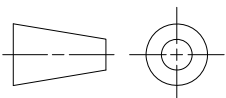

THIS DRAWING IS THE PROPERTY OF FULCRUM ACOUSTIC, AND SHALL NOT BE COPIED, REPRODUCED, OR USED AS THE BASIS FOR MANUFACTURE OR SALE OF APPARATUS WITHOUT WRITTEN AUTHORIZATION. DO NOT SCALE DRAWING.

UNLESS OTHERWISE SPECIFIED: ALL DIMENSIONS ARE IN INCHES

TOLERANCE IN INCHES  
 .X±.1 .XX±.015 .XXX±.005  
 FRACTIONS ±1/32  
 ANGLES ±1/2°

(X.XX) = REF DIMS NO TOLERANCE IMPLIED

TSC = THEORETICAL SHARP CORNER

DIMENSIONS ACROSS CENTERLINES TO BE SYMETRICAL

STATUS RELEASED

| APPROVALS    | DATE    |
|--------------|---------|
| DRAWN: RAF   | 4/21/20 |
| CHECKED: DEW | 4/21/20 |
| DES ENG:     |         |
| MFG ENG:     |         |



FULCRUM ACOUSTIC, LLC  
 670 LINWOOD AVE, LINWOOD, MA 01525 USA

TITLE: Mech Spec, YK-FH15 Ceiling Mount Yoke Bracket

A SHEET 1 OF 1 SCALE: 1:12  
 DWG. NO. 820-300-025 REV 5