

REVISIONS		
REV	DESCRIPTION	APPR / DATE
1	NEW ISSUE	01/19/21

Notes:

1. Fits: DX8 Series
2. Net Weight: Approx. 7.7 lb / 3.5 kg
3. Material: 8 GA ASTM A36 steel
4. Includes 2x each M6 socket head cap screws, split washers, and flat washers

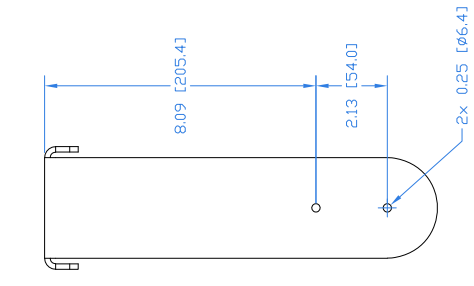
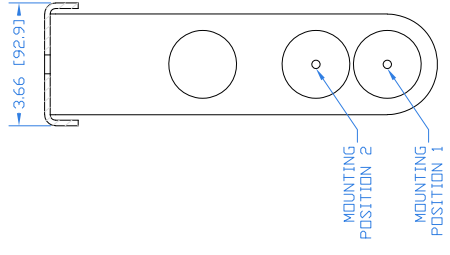
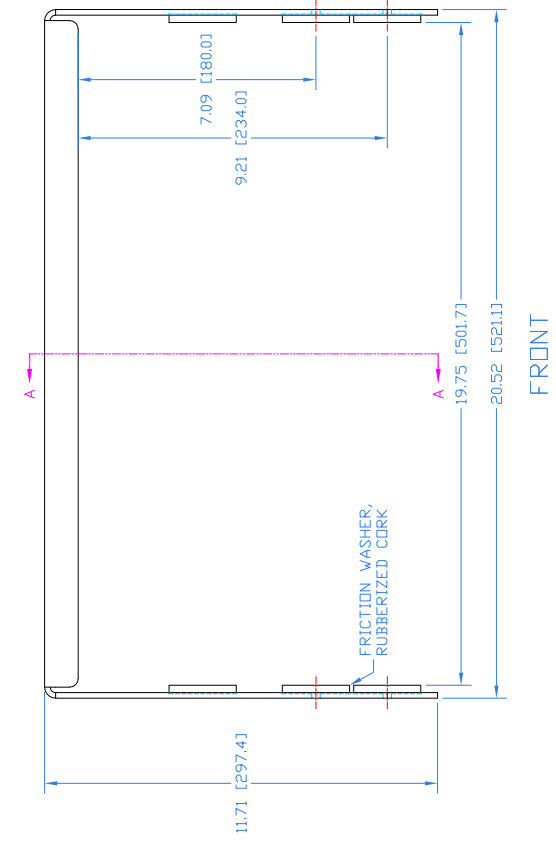
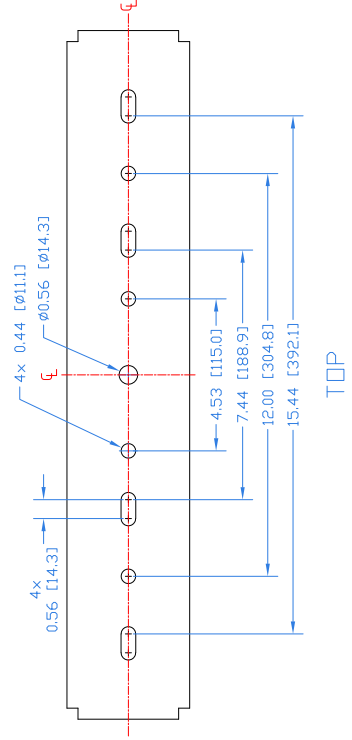

THIRD ANGLE PROJECTION

THIS DRAWING IS THE PROPERTY OF FULCRUM ACOUSTIC AND SHALL NOT BE COPIED, REPRODUCED, OR USED AS THE BASIS FOR MANUFACTURE OR SALE OF APPARATUS WITHOUT WRITTEN AUTHORIZATION. DO NOT SCALE DRAWING.

UNLESS OTHERWISE SPECIFIED:  
ALL DIMENSIONS ARE IN INCHES

TOLERANCE IN INCHES  
.X±.1 .XX±.015 .XXX±.005  
FRACTIONS ±1/32  
ANGLES ±1/2°

(XXX) = REF DIMS NO TOLERANCE IMPLIED  
TSC = THEORETICAL SHARP CORNER  
DIMENSIONS ACROSS CENTERLINES  
TO BE SYMMETRICAL

STATUS		RELEASED	DATE
APPROVALS	RAF		01/19/21
DRAWN:	RAF		
CHECKED:			
DES ENG:			
MFG ENG:			

FULCRUM ACOUSTIC, LLC  
670 LINWOOD AVE, WHITINSVILLE, MA 01588 USA

TITLE: Mechanical Spec,  
YK-DX8 Yoke Bracket

SCALE: 1:1

SHEET 1 OF 1

DWG. NO. 820-300-040

REV 1