

Notes:

1. Fits: CX15 Series & CCX15 Series
2. Net Weight: Approx. 9.6 lb / 4.4 kg
3. Material: **8 GA ASTM A36 steel**
4. Includes 2x each M10 socket head cap screws, split washers, and flat washers

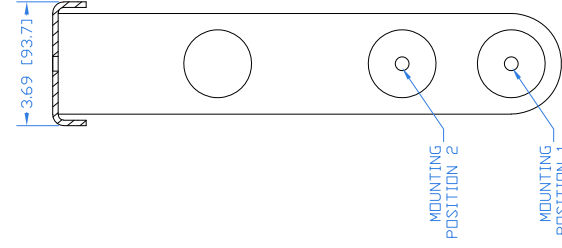
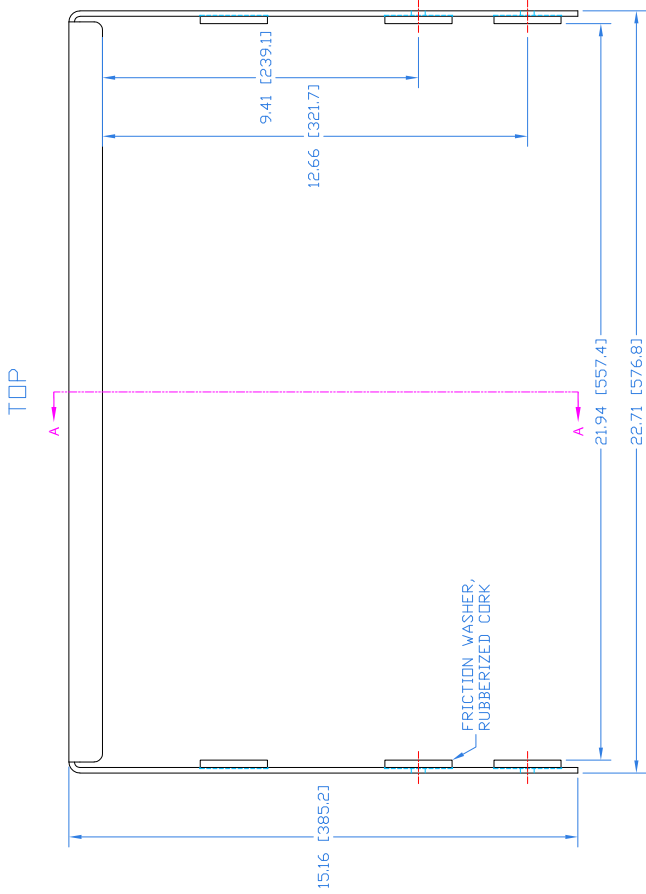
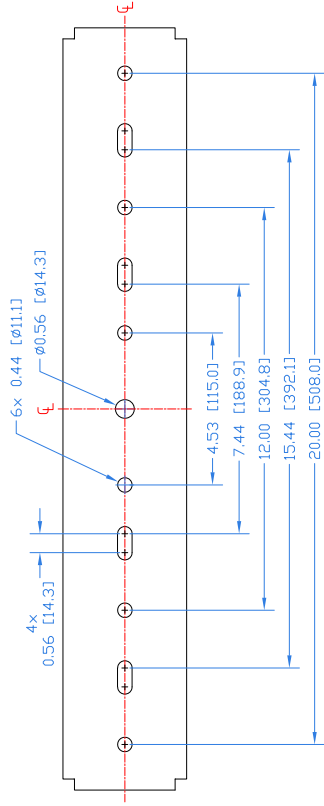

SECTION A-A RIGHT SIDE

REVISIONS

REV	DESCRIPTION	APPR / DATE
1	NEW ISSUE	06/29/20
2	UPDATE NOTES & WASHER QTY	01/14/21
3	ADD CCX15 REF TO NOTES	06/30/22

THIRD ANGLE PROJECTION

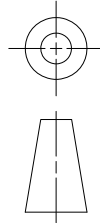

THIS DRAWING IS THE PROPERTY OF FULCRUM ACOUSTIC AND SHALL NOT BE COPIED, REPRODUCED, OR USED AS THE BASIS FOR MANUFACTURE OR SALE OF APPARATUS WITHOUT WRITTEN AUTHORIZATION.
DO NOT SCALE DRAWING.

UNLESS OTHERWISE SPECIFIED, ALL DIMENSIONS ARE IN INCHES

TOLERANCE IN INCHES
.XX±.015 .XXX±.005
FRACTIONS ±1/32
ANGLES ±1/2°

(X.XX) = REF DIMS NO TOLERANCE IMPLIED
TSC = THEORETICAL SHARP CORNER
DIMENSIONS ACROSS CENTERLINES TO BE SYMMETRICAL

STATUS RELEASED

APPROVALS	DATE
DRAWN: RAF	06/29/20
CHECKED: DWG	06/30/20
DES ENG:	
MFG ENG:	



FULCRUM ACOUSTIC, LLC
670 LINWOOD AVE, WHITINSVILLE, MA 01588 USA

TITLE:

Mechanical Spec,
YK-CX15 Yoke Bracket

A SHEET 1 OF 1 SCALE: 1:6

DWG. NO. 820-300-036 REV 3