

REVISIONS		
REV	DESCRIPTION	APPR / DATE
1	NEW ISSUE	12/14/20
2	UPDATE NOTES, MATERIAL, AND WASHER QTY	01/13/21

Notes:

1. Fits: CX12 Series & CCX12 Series
2. Net Weight: Approx. 7.9 lb / 3.6 kg
3. Material: 8 GA ASTM A36 steel
4. Includes 2x each M10 socket head cap screws, split washers, and flat washers

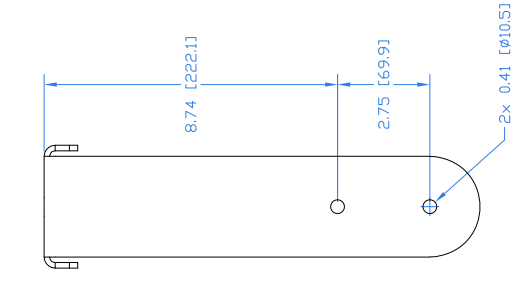
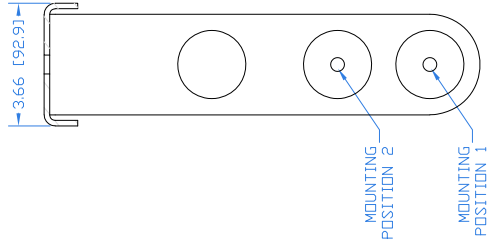
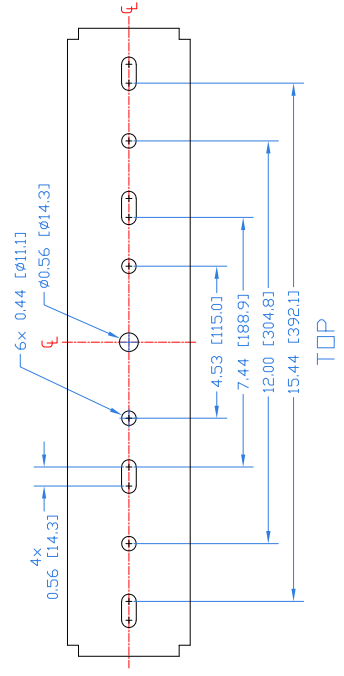

SECTION A-A

THIRD ANGLE PROJECTION		STATUS		RELEASED	
		APPROVALS	DATE	APPROVALS	DATE
<p>THIS DRAWING IS THE PROPERTY OF FULCRUM ACOUSTIC AND SHALL NOT BE COPIED, REPRODUCED, OR USED AS THE BASIS FOR MANUFACTURE OR SALE OF APPARATUS WITHOUT WRITTEN AUTHORIZATION. DO NOT SCALE DRAWING.</p>		DRAWN: RAF	12/14/20	DRAWN: RAF	12/14/20
		CHECKED: DWG	12/14/20	CHECKED: DWG	12/14/20
		DES ENG:		DES ENG:	
		MFG ENG:		MFG ENG:	
<p>UNLESS OTHERWISE SPECIFIED: ALL DIMENSIONS ARE IN INCHES TOLERANCE IN INCHES .XX±.015 .XXX±.005 FRACTIONS ±1/32 ANGLES ±1/2° (XXX) = REF DIMS NO TOLERANCE IMPLIED TSC = THEORETICAL SHARP CORNER DIMENSIONS ACROSS CENTERLINES TO BE SYMMETRICAL</p>		<p>RELEASED</p>		<p>FULCRUM ACOUSTIC, LLC 670 LINDOOD AVE, WHITINSVILLE, MA 01588 USA</p>	
<p>TITLE: YK-CX12 Yoke Bracket</p>		<p>APPROVALS</p>		<p>APPROVALS</p>	
<p>SCALE: 1:6</p>		<p>SHEET 1 OF 1</p>		<p>SCALE: 1:6</p>	
<p>REV 2</p>		<p>DWG. NO. 820-300-034</p>		<p>REV 2</p>	